



QUICK START GUIDE
快速入門指南

Charge 'n' Travel Adapter
35W Retractable Cable
30244

Charge 'n' Travel 通用旅行轉插
35W 配伸縮充電線
30244

How it works

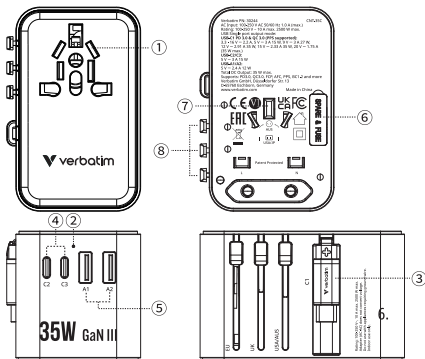

1. Multi-socket with safety shutter for child protection
2. Status LED
3. USB-C1 retractable cable PD 3.0 35 W
4. USB-C2/C3 15 W
5. USB-A1/A2 12 W
6. Fuse & Spare Fuse
7. Adapter plug Switches
8. Multi-plug

Connection

- Please insert the adapter into the socket. The Status LED will light up. If not, please check fuse.
- Then insert the plug of your device into the adapter.

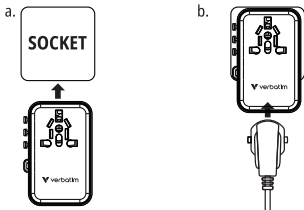

Connectivity

- The following plug types are accepted by the adapter:



Type A



Type B



Type C



Type E



Type F



Type G



Type I



Type J



Type L



Type N

Please notice that following plugs are not compatible:



Type D



Type H



Type K



Type M



Type O

Connectivity

2. You can plug the travel adapter into the following Type outlets:



Type A



Type B



Type C



Type D



Type E



Type F



Type G



Type I



Type J



Type L



Type N



Type O

Please find a full list of country compatibility on the related product page on our website.

2-POLE unearthed devices

The travel adapter is suitable for use with most electronic devices up to 2500 W at 250 V and 1000 W at 100 V.



The travel adapter is compatible with most USB devices.



Attention

Before use, move all sliders on the side completely back into their starting positions.

Selecting your plug

Find the power outlet of the country you want to plug your device into. The country outlets are shown next to the plugs.



Use EU Plug



Use UK Plug



Use USA Plug



Use AUS Plug

1. Move slider and move it forward to the other side, until the plug comes completely out and locks.
2. Recover the plug: Please press and hold the Adapter plug switch and sliding the back the Slider until the plug is pushed completely back inside of the adapter.
3. For AUS only: Turn the two connector contacts outwards until they form an inverted "V".
4. Now you can connect the adapter to the socket.

Retractable USB-C cable



1. Extend the integrated USB-C connector and pull cable to desired length.
2. Connect the USB-C cable to your device for charging
3. Disconnect the USB-C cable when charging is complete.
4. If you don't use it anymore:
Pull the cable gently to retract. Lower the USB-C connector to the magnet.



Changing the fuse

The travel adapter is equipped with a fuse, which automatically switches off if the adapter is overloaded. This happens when the current input from the socket exceeds 10 A or the terminal used requires more than 2500 W at 250 V or 1000 W at 110 V.

⚠ Before removing the fuse, unplug the travel adapter from the socket and disconnect all connected devices. If device was flooded with water or is wet, do not use until fully dried.

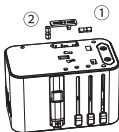

1. Pull out the fuse holder and remove the fuse.
2. Firmly press and turn the spare fuse cover and remove the spare fuse.
3. Place the spare fuse into the fuse holder and stick it back into the adapter.
4. Close the replacement cover.
5. Don't forget to get a new replacement fuse. Replacement fuse: 250 V 10 A, BS1362 approved.

Safety Instructions

- Protect the product from dirt, moisture and overheating and use it in dry rooms only.
- Do not drop the product and do not expose it to any major shocks.
- Do not operate the product outside the power limits given in the specifications.
- Use the product only for the intended purpose.
- As with all electrical products, this device should be kept out of the reach of children.
- Do not use the product in the immediate vicinity of heaters, other heat sources or in direct sunlight.
- Keep the packaging in a safe place for future reference. It contains important information.
- The product is intended only for use inside buildings.
- Only use the article under moderate climatic conditions (0°C-35°C, humidity below 80%).
- Do not use the product in areas in which electronic products are not permitted.
- Do not use the product in a damp environment and avoid splashing water.

Operation Warnings

Risk of electric shock

- Do not open the device or continue to operate it if it becomes damaged.
- Before connecting a device, check whether it is suitable for the voltage/mains frequency available in the country.
- Do not operate the product continuously, as it is not designed for this.
- Do not continue to operate the product if it is visibly damaged.
- The product is not designed for operation with other adapters.

Care and maintenance

- Disconnect the device from the mains before cleaning and during prolonged periods of non-use.
- Only operate the product from a socket that has been approved for the device. Plug devices directly into the adapter and the adapter directly into the socket.
- To disconnect please remove all devices from the adapter before removing the adapter from the socket.

Specifications

- **AC Input:** 100-250 V ~ 50/60 Hz 1.0A
- **Rating:** 100-250 V, 10 A max. 2500 W max.
Single port output mode:
- **USB-C1 PD 3.0 (PPS supported):**
3.3 V - 16 V = 2.2 A, 5 V = 3 A 15 W, 9 V = 3 A 27 W, 12 V = 2.91 A 35 W,
15 V = 2.33 A 35 W, 20 V = 1.75 A (35 W max.)
- **USB-C2/C3:**
5 V = 3 A (15 W max. each)
- **USB-A1/A2:**
5 V = 2.4 A (12 W max. each)

Specifications

Combined output mode:

2 Ports

- **USB-C1+Any other Ports:**

USB-C1: 5 V = 3 A 15 W, 9 V = 2.22 A 20 W, 12 V = 1.67 A 20 W (20 W max.)

Other ports: 5 V = 3 A (15 W max. sharing between the other ports)

- **Any combination without USB-C1 port output:**

5 V = 3 A (15 W max. sharing)

3 ports

- **USB-C1 + Any two ports:**

USB-C1: 5 V = 3 A 15 W, 9 V = 2.22 A 20 W, 12 V = 1.67 A 20 W (20 W max.)

Other ports: 5 V = 3 A (15 W max. sharing between the other ports)

- **Any combination without USB-C1 port output:**

5 V = 3 A (15 W max. sharing)

4 ports

- **USB-C1 + Any three ports:**

USB-C1: 5 V = 3 A 15 W, 9 V = 2.22 A 20 W, 12 V = 1.67 A 20 W (20 W max.)

Other ports: 5 V = 3 A (15 W max. sharing between the other ports)

- **C2 + C3 + A1 + A2:**

5 V = 3 A (15 W max. sharing)

5 ports

- **USB-C1 + (C2 + C3 + A1 + A2):**

USB-C1: 5 V = 3 A 15 W, 9 V = 2.22 A 20 W, 12 V = 1.67 A 20 W (20 W max.)

Other ports: 5 V = 3 A (15 W max. sharing between the other ports)

- **Total DC Output:** 35 W max.

- **Operating Temperature:** 0 - 40°C

- Support PD 3.0, QC 3.0, FCP, AFC, PPS, BC1-2 and more

- **Fuse:** 10 A BS1362 compliant

- Safety shutter for child protection (can only be opened with force of more than 75N (7.5Kg) per hole)

- **Dimensions (L x W x H):** 84mm x 55mm x 54mm

- **Weight:** 193g

CAUTION

- Before use, please read this instruction carefully! This product does not convert voltage (AC-AC), to avoid possible damage to your device or other safety hazards, please make sure the power outlet you intend to use has the proper voltage to run your device before using this adapter.
- Each country has its own regulations regarding the use of travel adapters, please check in each country before use.
- No grounding: This product is for use with unearthed or double insulated appliances only.
- Indoor use only.



CAUTION

Misuse can lead to electrical shock.

Verbatim Limited Warranty Terms

Verbatim warrants this product to be free from defects in material and workmanship for a period of 2 years from date of purchase.

This warranty excludes batteries.

If this product is found to be defective within the warranty period, it will be replaced at no cost to you.

You may return it with your original cash register receipt to the place of purchase or contact Verbatim.

Product replacement is your sole remedy under this warranty, and this warranty does not apply to normal wear or to damage resulting from abnormal use, misuse, abuse, neglect or accident, or to any incompatibility or poor performance due to the specific computer software or hardware used.

VERBATIM WILL NOT BE LIABLE FOR DATA LOSS OR ANY INCIDENTAL, CONSEQUENTIAL OR SPECIAL DAMAGES, HOWEVER CAUSED, FOR BREACH OF WARRANTIES OR OTHERWISE.

This warranty gives you specific legal rights and you may also have other rights which vary from state to state or country to country.

運作方式

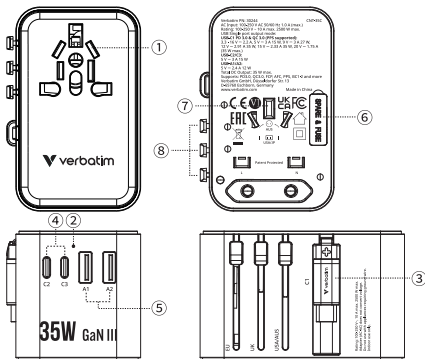

1. 多功能插座，配備兒童保護安全活門
2. LED 狀態指示燈
3. USB-C1 可伸縮充電線 PD 35 W
4. USB- C2/C3 15 W
5. USB- A1/A2 12 W
6. 保險絲及備用保險絲
7. 多功能適配器
8. 多功能適配器開關

連接使用

- 請將適配器插入插座，LED 狀態顯示燈將會亮起。
如果沒有亮起，請檢查保險絲。
- 然後將設備的插頭插入適配器。

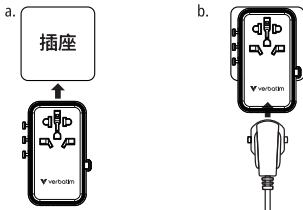

連接性

- 適配器接受以下插頭類型：

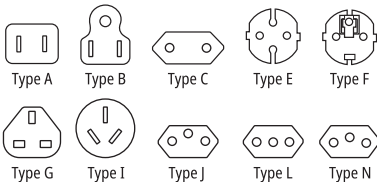

- 請注意，以下插頭不相容：

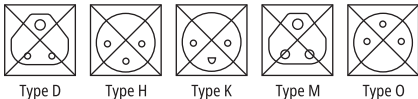

連接性

2. 您可以將旅行適配器插入以下類型的插座：



Type A



Type B



Type C



Type D



Type E



Type F



Type G



Type I



Type J



Type L



Type N



Type O

請在我們網站內相關產品頁面上找到國家/地區相容性的完整清單。

雙極未接地設備

旅行適配器適用於大多數電子設備，最大功率為2500 W (250V) 和 1000 W (100 V)。



旅行適配器與大多數 USB 設備相容。



注意

使用前，將側面所有推拉鍵推回原位置。

選擇使用插頭

找出適合您要將設備插入使用到的國家/地區的電源插座。國家/地區插座顯示在插頭旁邊。



使用歐規插頭



使用英規插頭



使用美規插頭



使用澳規插頭

1. 輕輕按下所需的推拉桿並將其向前移動到另一側，直到插頭完全拔出並鎖定。
2. 請按住推拉桿。鬆開保持位置並繼續將其拉回另一側，直到插頭完全推回適配器內部。
3. 僅適用於 AUS：將兩個連接器觸點向外轉動，直到它們形成一個倒的“V”形。
4. 現在您可以將適配器連接到插座。

可伸縮 USB-C 充電線



1. 延長整合的 USB-C 連接器並將充電線拉至所需長度。
2. 將 USB-C 充電線連接到您的裝置進行充電。
3. 充電完成後，斷開 USB-C 充電線。
4. 如果您不再使用它：輕輕拉動充電線以便縮回。將 USB-C 連接器拉下到磁鐵上。



更換保險絲

旅行適配器配有保險絲，如果適配器過載，保險絲會自動關閉。當來自插座的電流輸入超過 10 A 或所使用的端子需要超過 2500 W (250 V) 或 1000 W (110 V) 時，就會發生這種情況。

△ 在取下保險絲之前，請從插座上拔下旅行適配器並斷開所有連接的設備。如果設備被水淹沒或潮濕，請勿在沒有完全乾燥的情況下使用。

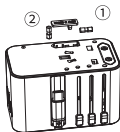

1. 拉出保險絲座並取下保險絲
2. 用力按壓並轉動方形保險絲蓋，取下備用保險絲。
3. 將備用保險絲放入保險絲座中，然後將其插回轉接器中。
4. 合上更換蓋板上更換蓋板。
5. 不要忘記更換新的保險絲。替換保險絲：250 V 10 A，符合 BS1362 標準。

安全指導

- 保護產品免受污垢、濕氣和過熱的影響，並僅在乾燥的房間中使用。
- 請勿掉落產品，也不要使其受到任何重大衝擊。
- 請勿在規格中給出的功率限制之外操作產品。
- 僅將產品用於預期目的。
- 與所有電器產品一樣，本設備應放在兒童接觸不到的地方。
- 請勿在加熱器附近、其他熱源或陽光直射下使用本產品。
- 將包裝保存在安全的地方以備將來參考。它包含重要資訊。
- 該產品僅供建築物內部使用。
- 僅在溫和的氣候條件 (0°C-35°C，濕度低於 80%) 下使用。
- 請勿在不允許使用電子產品的區域使用本產品。
- 請勿在潮濕環境中使用本產品，並避免濺水。

操作警告

觸電危險

- 如果設備損壞，請勿打開或繼續操作。
- 在連接設備前，請檢查它是否適合該國可用的電壓/電源頻率。
- 請勿連續操作產品，因為它不是為此而設計的。
- 如果產品有明顯損壞，請勿繼續操作。
- 該產品不是與其他適配器一起使用而設計的。

保養和維護

- 在清潔之前和長時間不使用時，請斷開設備與電源的連接。
- 只能從已批准用於該設備的插座操作產品。將設備直接插入適配器，將適配器直接插入插座。
- 要斷開連接，請先從適配器中取出所有設備，然後再從插座中取出適配器。

產品規格

- **AC 輸出:** 100-250 V 50/60Hz 1.0 A
- **額定值:** 100-250 V, 10 A max. 2500 W max.
單口輸出模式:
- **USB-C1 PD 3.0 (支援 PPS):**
3 V - 16 V = 2.2 A, 5 V = 3 A 15 W, 9 V = 3 A 27 W, 12 V = 2.91 A 35 W,
15 V = 2.33 A 35 W, 20 V = 1.75 A (最大 35 W)
- **USB-C2/C3:**
5 V = 3 A (每個最大 15 W)
- **USB-A1/A2:**
5 V = 2.4 A (每個最大 12 W)

組合輸出模式:

2 端口

- **USB-C1 + 任何端口:**
USB-C1: 5 V = 3 A 15 W, 9 V = 2.22 A 20 W, 12 V = 1.67 A 20 W (最大 20 W)
其他端口: 5 V = 3 A (最大 15 W, 與其他端口共享)
- **不含 USB-C1 端口輸出的任意組合:**
5 V = 3 A (最大 15 W 共享)

產品規格

3 端口

- **USB-C1 + 任何 2 個端口:**

USB-C1: 5 V = 3 A 15 W, 9 V = 2.22 A 20 W, 12 V = 1.67 A 20 W (最大 20 W)

其他端口: 5 V = 3 A (最大 15 W, 與其他端口共享)

- **不含 USB-C1 端口輸出的任意組合:**

5 V = 3 A (最大 15 W 共享)

4 端口

- **USB-C1 + 任何 3 個端口:**

USB-C1: 5 V = 3 A 15 W, 9 V = 2.22 A 20 W, 12 V = 1.67 A 20 W (最大 20 W)

其他端口: 5 V = 3 A (最大 15 W, 與其他端口共享)

- **C2 + C3 + A1 + A2:**

5 V = 3 A (最大 15 W 共享)

5 端口

- **USB-C1 + (C2 + C3 + A1 + A2):**

USB-C1: 5 V = 3 A 15 W, 9 V = 2.22 A 20 W, 12 V = 1.67 A 20 W (最大 20 W)

其他端口: 5 V = 3 A (最大 15 W, 與其他端口共享)

- **總電流輸出:** 35 W max.

- **工作溫度:** 0 - 40°C

- **支援 PD 3.0, QC 3.0, FCP, AFC, PPS, BC1-2 等**

- **Fuse:** 符合 BS1362 標準的 10 A 保險絲

- **配備兒童保護安全活門, 每個插孔需要施加大於 75N (7.5Kg) 的力才能插入。**

- **尺寸(長 x 寬 x 高):** 84毫米 x 55毫米 x 54毫米

- **產品重量:** 193克

警告

- 使用前，請仔細閱讀本說明書！本產品不會轉換電壓 (AC-AC)，為避免可能損壞您的裝置或其他安全隱患，請在使用此轉接器之前確保您打算使用的電源插座具有適合您的裝置運作的電壓。
- 每個國家對於旅行適配器的使用都有自己的規定，請在使用前檢查每個國家的規定。
- 無接地：本產品僅適用於不接地或雙重絕緣設備。
- 僅限室內使用。



警告

誤用可能導致觸電。

Verbatim 有限保固條款

Verbatim 保證本產品自購買日起 2 年內不存在材料和工藝缺陷。此保固不包括電池。如果在保固期內發現本產品有缺陷，我們將免費為您更換。您可以將其與購買收據一起退回購買地點或聯絡 Verbatim。

跟據本保固條款，更換產品是對不良產品的唯一處理方式，本保固不適用於正常磨損或因非正常使用、誤用、濫用、疏忽或事故所因至之損壞，或因特定電腦軟體或硬體而導致的任何不相容或效能不佳。

對於任何資料損失或因意外、違反保固條款造成或特殊損害(無論何種原因造成)，Verbatim 概不負責。

本保固賦予您特定的合法權利，您也可能擁有因州或國家而異的其他權利。

備註

Verbatim 可能隨時修改本使用者指南的內容，恕不另行通知。

版權

版權所有© 2026 Verbatim。未經 Verbatim 明確書面許可，不得以任何形式或任何方式複製本文檔的任何部分。

版權所有。

本文所引用的所有其他品牌和產品名稱均為其各自所有者的財產。

Technical Support and Documentation Technischer Support und Dokumentation Support technique et documentation

- Ⓔ To download the user manual, access frequently asked questions or contact the Verbatim support team, please go to – www.verbatim.com/support.
- Ⓕ Pour télécharger le manuel d'utilisation, accéder aux questions fréquemment posées ou contacter l'équipe d'assistance Verbatim, veuillez vous rendre sur – www.verbatim.com/support.
- Ⓖ Um die Betriebsanleitung herunterzuladen, auf häufig gestellte Fragen zuzugreifen oder das Verbatim-Supportteam zu kontaktieren, gehen Sie bitte auf – www.verbatim.com/support.
- Ⓝ Om de gebruikershandleiding te downloaden, veegestelde vragen te raadplegen of contact op te nemen met het Verbatim-ondersteuningsteam, gaat u naar – www.verbatim.com/support.
- Ⓜ Per scaricare il manuale utente, vedere le risposte alle domande più frequenti o contattare il team di Assistenza Verbatim, visita la pagina – www.verbatim.com/support.
- Ⓔ Para descargar el manual de usuario, acceder a las preguntas más frecuentes o ponerse en contacto con el equipo de asistencia de Verbatim, visite – www.verbatim.com/support.
- Ⓜ Para descarregar o manual do utilizador, aceder às perguntas mais frequentes ou contactar a equipa de apoio Verbatim, por favor vá a – www.verbatim.com/support.
- Ⓜ Aby pobrać instrukcję obsługi, uzyskać odpowiedzi na często zadawane pytania lub skontaktować się z zespołem pomocy technicznej, proszę przejść na stronę www.verbatim.com/support.
- Ⓜ Чтобы загрузить руководство пользователя, ознакомиться с часто задаваемыми вопросами или связаться со службой поддержки Verbatim, перейдите по адресу – www.verbatim.com/support.
- Ⓒ Chcete-li si stáhnout uživatelskou příručku, získat přístup k často kladeným otázkám nebo kontaktovat tým podpory společnosti Verbatim, přejděte na stránku – www.verbatim.com/support.

Technical Support and Documentation Technischer Support und Dokumentation Support technique et documentation

- Ⓜ A felhasználói kézikönyv letöltéséhez, a gyakran ismételt kérdések eléréséhez vagy a Verbatim ügyfélszolgálatával való kapcsolatfelvételhez kérjük, látogasson el a www.verbatim.com/support weboldalra.
- Ⓜ Για να κατεβάσετε το εγχειρίδιο χρήσης, να αποκτήσετε πρόσβαση σε συχνές ερωτήσεις ή να επικοινωνήσετε με την ομάδα υποστήριξης της Verbatim, επισκεφθείτε την ιστοσελίδα – www.verbatim.com/support.
- ⓂⓂ Za preuzimanje korisničkog priručnika, pristupite često postavljanim pitanjima ili kontaktirajte Verbatim tim za podršku, idite na – www.verbatim.com/support.
- Ⓜ Ak si chcete stiahnuť používateľskú príručku, získať prístup k často kladeným otázkam alebo kontaktovať tím podpory spoločnosti Verbatim, prejdite na – www.verbatim.com/support.
- Ⓜ Pentru a descărca manualul de utilizare, pentru a accesa întrebările frecvente sau pentru a contacta echipa de asistență Verbatim, vă rugăm să accesați – www.verbatim.com/support.
- Ⓜ Kullanım kılavuzunu indirmek, sık sorulan sorulara erişmek veya Verbatim destek ekibiyle iletişime geçmek için lütfen şu adrese gidin - www.verbatim.com/support.
- Ⓜ 關於常見問題的解答，可以下載產品使用手冊或聯繫 Verbatim 的支援團隊，請登入 - www.verbatim.com/support。
- Ⓜ 关于常見問題的解答，可以下載產品使用手冊或联系 Verbatim 的支持團隊，請登入 - www.verbatim.com/support。
- Ⓜ 사용 설명서 다운로드, 자주 묻는 질문 확인 또는 버batim 지원팀에 직접 문의하시려면 www.verbatim.com/support 로 접속하십시오.
- Ⓜ ユーザーマニュアルのダウンロード、よくあるご質問、サポート情報については、www.verbatim.com/support をご参照ください。



www.verbatim.com

- EUROPE/MIDDLE EAST/AFRICA/INDIA: Verbatim GmbH, Düsseldorf StraÙe 13, 65760 Eschborn, Germany
- AMERICAS: Verbatim Americas LLC, Charlotte, NC 28262, USA
- AUSTRALIA/ NEW ZEALAND: Verbatim Australia Pty Ltd, 36-40 Pacific Drive Keysborough, Victoria, 3173 Australia
Tel: +61 3 9790 8999 Fax: +61 3 9790 8955
mail: support@verbatim.com.au
- ASIA: Verbatim Hong Kong Ltd, Unit 701, 7/F, Tower 2, South Seas Centre, 75 Mody Road, Tsimshatsui East, Kowloon, Hong Kong
- Japan: Verbatim Japan LTD., 2-15-4 Kandatsukasamachi, Chiyoda-ku, Tokyo 101-0048, Japan
- 中国销售公司: 深圳华浩科技信息有限公司
公司地址: 深圳市龙岗区坂田街道象角塘社区源创空间-雪象园A2栋三层310室

