

**User Manual / 사용자 매뉴얼 /  
產品手冊 / 產品手冊**

**Model: VAPWC202**

---

## **Introduction:**

Thank you for choosing this Verbatim product. Please read this manual carefully prior to use so as to fully understand the product and its correct usage.

---

## **Caution:**

- Do not alter, modify or disassemble the charging device. There are no user-serviceable parts inside, and incorrect reassembly may result in shock or fire hazard.
  - Do not drop or subject the charging device to strong mechanical shock. Do not expose to moisture, water, rain, snow, spray, heat or sources of ignition.
  - Use a damp soft cloth to clean the surface of the case. Do not use chemical solvents.
  - Contact our customer support team if you have troubleshooting issues with this product.
  - Do not operate the charging device if it has been dropped or otherwise damaged in anyway.
  - Keep out of reach of children.
  - To reduce the risk of electric shock, unplug the charging device from any power source before attempting maintenance and cleaning.
- 

## **Package Contents:**

- 1 x Magnetic wireless charger
- 1 x Dashboard mount
- 1 x Car vent clip
- 1 x Type C to Type C cable
- 1 x Metallic Ring

## Specifications:

Product name: 15 W Magnetic Wireless Car Charger with Refrigerated Freeze Technology

Materials: Flame Resistant PC + ABS

Type C Input: 9 V  $\equiv$  2-3 A, 12 V  $\equiv$  2-3 A Max

Wireless Output: 5 W, 7.5 W, 10 W, 15 W (iPhone models up to 7.5 W)

Operating Temperature: 0°C - 40°C

Dimensions: 64 x 64 x 42.5mm (Magnetic wireless charger)

Weight: 101g (Magnetic wireless charger)

Limited Warranty: One Year

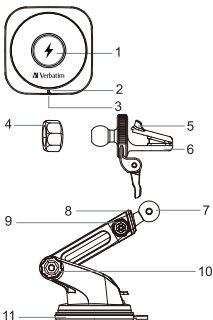

1. Wireless Charging Zone
2. LED Light Indicator
3. Type C Input Power Port
4. Stabilising Nut
5. Clamp Handle
6. Air Vent Clamp
7. 360° Swivel Ball
8. Adjustable Arm
9. Arm Release Knob
10. Angle Adjustor
11. Suction Cup

## LED Light Indicators:

- Power On - Green light
- Charging - Blue light
- Fully Charged - Blue light
- FOD Protection (Foreign Object Detection) - Green & blue light

## Installing the Mount:

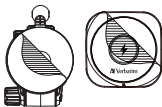

- 1 Remove the protective film from the suction cup and magnetic wireless charger. Stick the suction cup onto a clean, flat surface.

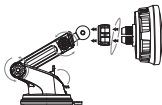

- 2 Click the ball into the connecting joint. Screw the stabilising nut to firmly lock in place.



- 3 Connect the Type C cable to power port.



- 4 Place your phone on the magnetic wireless charger for charging. For best results, we recommend not using a phone case, or ensure the case is less than 2mm thick.

## Installing the Car Vent Clip:



- 1 Remove the protective film from the magnetic wireless charger.

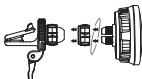

- 2 Click the ball into the connecting joint. Screw the stabilising nut to firmly lock in place.



- 3 Connect the Type C cable to power port.



- 4 Place your phone on the magnetic wireless charger for charging. For best results, we recommend not using a phone case, or ensure the case is less than 2mm thick.

 **Verbatim.**

**CE FCC**

**RoHS**



R-R-3mC-IC-70CS.

1 Year Limited Warranty – for further details visit [www.verbatim.com/warranty](http://www.verbatim.com/warranty)

**Verbatim Australia Pty Ltd (ABN 39 005 706 374)**

- **Warranty Statement**

Our goods come with guarantees that cannot be excluded under the Australian Consumer Law. You are entitled to a replacement or refund for a major failure and for compensation for any other reasonably foreseeable loss or damage. You are also entitled to have the goods repaired or replaced if the goods fail to be of acceptable quality and the failure does not amount to a major failure.

Verbatim Australia Pty Ltd (ABN 39 005 706 374) ("Verbatim") provides the following warranty in relation to its goods ("Product").

The benefits of this warranty are in addition to any rights and remedies imposed by Australian State & Federal legislation that cannot be excluded. Nothing in this warranty is to be interpreted as excluding, restricting or modifying any State or Federal legislation applicable to the supply of goods and services which cannot be excluded, restricted or modified.

Verbatim warrants that, subject to the exclusions and limitations below, the Product will be free from defects in materials and workmanship for the period specified on the product packaging and/or the website from date of purchase.

If a defect appears in the Product before the end of the warranty period and Verbatim finds the Product to be defective in materials and workmanship, Verbatim will at its own discretion repair or replace the Product free of charge. If goods presented for repair are capable of retaining user-generated data, repair of these goods may result in loss of the data.

- **Proof of Purchase**

Proof of purchase shall be required to be eligible for this warranty and to establish the commencement date of this warranty. This warranty is valid for the original purchase only and is not transferrable to a subsequent customer if the Product is sold by the original customer during the warranty period.

The term of your warranty period shall commence from the purchase date appearing on your purchase receipt from an authorised distributor, reseller or retailer and extends only for the time set forth in the Product documentation. This information can be obtained from the packaging and/or the Verbatim Australia website.

- **Returned Merchandise Authorisation**

No product may be returned to Verbatim Australia without first contacting us for a RMA (Returned Merchandise Authorisation) number. If it is determined that a

Product may be defective, you will be given an authorisation number and instructions for Product return. An unauthorised return, i.e. one for which an RMA number has not been issued, will be returned to you at your expense. Authorised returns are to be shipped prepaid and insured to our Head Office in qualified packaging.

- **Warranty Claims**

- 1) If a fault covered by warranty occurs, the customer must first:
  - a) Contact Verbatim Australia Head Office using the contact details provided below; or
  - b) Return the Product to the retailer from which the Product was purchased.
- 2) Any warranty claim must be accompanied by:
  - a) Proof of purchase; and b) Full details of the alleged defect.
- 3) If Verbatim or the retailer from which the Product was purchased finds no defect in the Product after inspection and testing, the customer must pay Verbatim's usual costs of service work and testing.
- 4) The customer must bear the cost of the transport to Verbatim or to and from the retailer to make the warranty claim including all insurance of the Product. Verbatim will bear the cost of the return transport to the customer once the claim has been finalised.

- **Exclusions**

The warranty will not apply where:

- 1) The Product has been repaired, altered or modified by someone other than Verbatim or an authorised repair agent;
- 2) The alleged defect in the Product is within acceptable industry variances;
- 3) Verbatim cannot establish any fault in the Product after testing and inspection;
- 4) The Product has been used other than for the purpose for which it was designed;
- 5) The defect in the Product has arisen due to the customer's failure to properly use and maintain the Product in accordance with Verbatim's instructions, recommendations and specifications (including applicable maintenance schedules);
- 6) The Product has been subject to abnormal conditions or use, including environment, temperature, water, fire, humidity, pressure, stress or similar;

- 7) The defect has arisen due to abuse, misuse, neglect or accident.
- The warranty does not extend to:
    - 1) Damage or defects caused by normal wear and tear;
    - 2) General, consequential, punitive, incidental or special damages. These include loss of recorded data, interruption of use, the cost of recovery of lost data, lost profits and the cost of the installation or removal of any Products, the installation of replacement Products, and any inspection, testing or redesign caused by any defect or by the repair or replacement of Products arising from a defect in any Product.
    - 3) Incompatibility or poor performance due to specific computer or hardware used.
  - Limitations

Verbatim makes no express warranties or representations other than set out in this warranty.

The replacement of the Product or part of the Product is the absolute limit of Verbatim's liability under this express warranty.

- Contact Details

Verbatim Australia Pty Ltd

Unit 6, 450 Princes Highway, Noble Park, Victoria 3174, Australia

Tel: +61 3 9790 8999 Fax: +61 3 9790 8955

Email: [support@verbatim.com.au](mailto:support@verbatim.com.au)

Website: [www.verbatim.com.au](http://www.verbatim.com.au)



---

## 소개:

버바팀 제품을 선택하여 주셔서 감사합니다. 제품에 대한 이해와 올바른 사용을 위해 사용 전, 이 매뉴얼을 숙지하여 주시기 바랍니다.

---

## 주의:

- 충전기를 수리, 수정, 변경하지 마십시오. 내부에는 사용자가 수리할 수 있는 부품이 없습니다. 잘못된 재조립으로 충격이나 화재의 위험이 발생할 수 있습니다.
  - 충전기를 떨어뜨리거나 강한 충격을 가하지 마십시오. 충전기가 습기, 물, 비, 눈, 스프레이, 열, 발화원, 직사광선에 노출되지 않도록 하십시오.
  - 표면은 부드러운 천으로 닦으십시오. 화학용제를 사용하지 마십시오.
  - 이 제품에 대한 문의나 문제 해결에 대해서는 고객 지원팀에 연락하시기 바랍니다.
  - 충전기를 떨어뜨리거나 충전기에 손상이 가해졌을 경우에는 충전기를 작동하지 마십시오.
  - 어린이의 손이 닿지 않는 곳에 보관하십시오.
  - 감전 등의 위험을 줄이기 위해 유지 보수 전에는 전원 플러그를 해체하여 주십시오.
- 

## 구성품:

- 1 x 무선 충전 스마트폰 거치대
- 1 x 대쉬 보드 스탠드
- 1 x 차량 송풍구 클립
- 1 x Type C to Type C 케이블
- 1 x 메탈릭 링

## 제품사양:

제품명: 15W 마그네틱 무선 쿨링 차량용 충전기

재질: 난연제 PC + ABS

Type C 입력: 최대 9 V  $\rightleftharpoons$  2-3 A, 12 V  $\rightleftharpoons$  2-3 A

무선 출력: 최대 5 W, 7.5 W, 10 W, 15 W (아이폰 모델: 최대 7.5 W)

작동온도: 0°C - 40°C

제품크기: 64 x 64 x 42.5mm (마그네틱 무선 충전기)

제품무게: 101g (마그네틱 무선 충전기)

품질보증: 1년

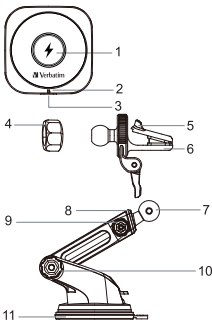

1. 무선 충전존
2. LED 상태 표시등
3. Type C 입력 전원 포트
4. 조절넛
5. 고정 핸들
6. 송풍구 클립
7. 360° 회전볼
8. 조절대
9. 조절대 조절넛
10. 앵글 조절대
11. 흡착컵

## LED 상태 표시등 :

- 전원 on - 초록 LED
- 충전 - 파란 LED
- 완충 - 파란 LED
- FOD 보호(이물질 감지) - 초록 & 파란 LED

## 거치대 설치:

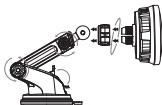
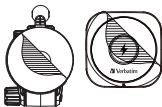

- 1 흡착컵과 마그네틱 무선 충전기의 보호필름을 제거 하신 후, 흡착컵을 깨끗하고 편평한 곳에 부착하십시오.
- 2 볼을 연결 조인트에 딸깍 소리가 나도록 연결하십시오. 단단히 고정되도록 조절너를 조이십시오.
- 3 Type C 케이블을 연결하십시오.
- 4 핸드폰을 마그네틱 무선 충전기에 올려 충전 하십시오. 보다 안정적인 충전을 위해 핸드폰 케이스를 제거하고 충전할 것을 권장합니다.

## 송풍구 클립 설치:

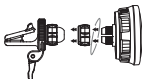

- 1 마그네틱 무선 충전기의 보호필름을 제거하십시오.
- 2 볼을 연결 조인트에 딸깍 소리가 나도록 연결하십시오. 단단히 고정되도록 조절너트를 조이십시오.
- 3 Type C 케이블을 연결 하십시오.
- 4 핸드폰을 마그네틱 무선 충전기에 올려 충전 하십시오. 보다 안정적인 충전을 위해 핸드폰 케이스를 제거하고 충전할 것을 권장합니다.

**Verbatim**



R-R-3mC-4C-70CS.

1년의 제한된 품질보증 -  
보다 자세한 정보는 [www.verbatim.com/warranty](http://www.verbatim.com/warranty)를 참고 하십시오

---

## 前言：

感謝您選購並使用Verbatim產品，為讓您能夠更好的使用本產品的所有功能，請您在正式使用本產品前，仔細閱讀本手冊內所提及的注意事項以及詳細功能操作說明。

---

## 注意事項：

- 請不要變更，修改或拆開充電設備。內部沒有用戶可維修的零件。不正確的拆裝可能會導致觸電或火災。
  - 請不要摔落或讓充電設備承受強烈的衝擊。請不要將充電設備暴露在潮濕環境、水、雨、雪、噴霧、熱或火源。
  - 可用擰乾的濕棉布輕輕擦抹充電器的外殼，嚴禁使用其他化學溶液清洗。
  - 如在使用本產品上遇到任何問題，請聯繫我們的客戶支援團隊。
  - 請勿操作已受損的充電設備，包括受到摔落或其他形式的損壞。
  - 放置於讓兒童接觸不到的地方。
  - 為了減少觸電危險，在嘗試任何維護或清理前，必須拔除充電器的任何電源。
- 

## 包裝內容：

- 1 x 磁吸無線充電器
- 1 x 儀表板支架
- 1 x 汽車通風夾
- 1 x Type C至Type C連接線
- 1 x 金屬環

## 產品規格：

- 產品名稱：15W 磁吸無線車用充電器(內置冷凍技術)
- 物料：阻燃PC + ABS
- Type C 輸入：最大 9 V = 2-3 A，12 V = 2-3 A
- 無線輸出：5 W, 7.5 W, 10 W, 15 W (iPhone型號手機最高為7.5 W)
- 工作溫度：0°C - 40°C
- 產品尺寸：64 x 64 x 42.5毫米 (磁吸無線充電器)
- 產品重量：101克 (磁吸無線充電器)
- 保養期：一年有限保養

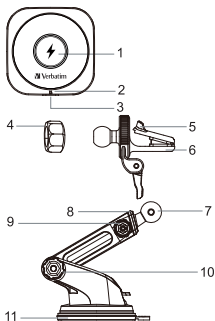

1. 無線充對應位置
2. LED指示燈
3. Type C 電源輸入端口
4. 固定螺母
5. 開合手柄
6. 出風口夾子
7. 360度旋轉球
8. 伸縮杆
9. 伸縮杆旋鈕
10. 角度調整旋鈕
11. 吸盤

## LED燈指示燈：

- 開啓電源 - 綠色指示燈亮起
- 充電中 - 藍色指示燈亮起
- 充滿電 - 藍色指示燈亮起
- FOD保護 (異物檢測) - 綠色和藍色指示燈亮起

## 安裝支架指引：

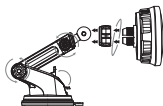
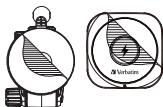

- 1 移除吸盤底部和磁吸無線充電器表面上的保護膜，並把吸盤貼緊於乾淨平面。
- 2 將儀表板支架套入充電器背部的固定孔，順時針鎖緊旋轉球固定螺母，調整支架臂及伸縮杆至最方便合適角度。
- 3 把Type C充電線連接至電源輸入端口。
- 4 將手機放在磁吸無線充電器上充電。為獲得最佳效果，我們建議不要使用手機殼或手機殼必須小於 2 毫米厚度。

## 安裝汽車通風夾：

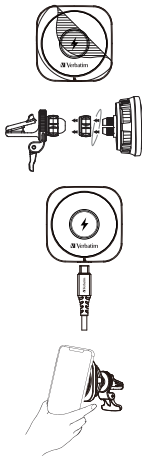

- 1 移除磁吸無線充電器表面上的保護膜。
- 2 將出風口夾子套入固定孔。順時針鎖緊旋轉球固定螺母。
- 3 把Type C充電線連接至電源輸入端口。
- 4 將手機放在磁吸無線充電器上充電。為獲得最佳效果，我們建議不要使用手機殼或手機殼必須小於 2 毫米厚度。

 Verbatim.

CE FCC

RoHS



R-R-3mC-IC-70CS.

1年有限保固 - 詳情請瀏覽 [www.verbatim.com/warranty](http://www.verbatim.com/warranty)

TC



---

## 前言：

感谢您选购并使用Verbatim产品，为让您能够更好的使用本产品的所有功能，请您在正式使用本产品前，仔细阅读本手册内所提及的注意事项以及详细功能操作说明。

---

## 注意事项：

- 请不要变更，修改或拆开充电设备。内部没有用户可维修的零件。不正确的拆装可能会导致触电或火灾。
  - 请不要摔落或让充电设备承受强烈的冲击。请不要将充电设备暴露在潮湿环境、水、雨、雪、喷雾、热或火源。
  - 可用拧乾的湿棉布轻轻擦抹充电器的外壳，严禁使用其他化学溶液清洗。
  - 如在使用本产品上遇到任何问题，请联系我们的客户支持团队。
  - 请勿操作已受损的充电设备，包括受到摔落或其他形式的损坏。
  - 放置于让儿童接触不到的地方。
  - 为了减少触电危险，在尝试任何维护或清理前，必须拔除充电器的任何电源。
- 

## 包装内容：

- 1 x 磁吸无线充电器
- 1 x 仪表板支架
- 1 x 汽车通风夹
- 1 x Type C至Type C连接线
- 1 x 金属环

## 产品规格：

- 产品名称：15W 磁吸无线车载充电器(内置冷冻技术)
- 物料：阻燃PC + ABS
- Type C 输入：最大  $9\text{ V} \equiv 2\text{-}3\text{ A}$ ， $12\text{ V} \equiv 2\text{-}3\text{ A}$
- 无线输出：5 W, 7.5 W, 10 W, 15 W (iPhone型号手机最高为7.5 W)
- 工作温度： $0^{\circ}\text{C}$  -  $40^{\circ}\text{C}$
- 产品尺寸：64 x 64 x 42.5毫米 (磁吸无线充电器)
- 产品重量：101克 (磁吸无线充电器)
- 质保期：一年有限质保

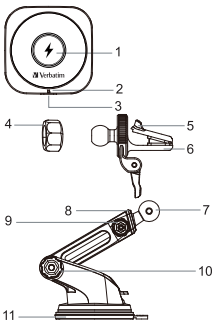

1. 无线充对应位置
2. LED指示灯
3. Type C 电源输入端口
4. 固定螺母
5. 开合手柄
6. 出风口夹子
7. 360度旋转球
8. 伸缩杆
9. 伸缩杆旋钮
10. 角度调整旋钮
11. 吸盘

## LED灯指示灯：

- 开启电源 - 绿色指示灯亮起
- 充电中 - 蓝色指示灯亮起
- 充满电 - 蓝色指示灯亮起
- FOD保护 (异物检测) - 绿色和蓝色指示灯亮起

## 安装支架指引：

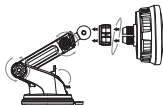
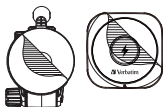

- 1 移除吸盘底部和磁吸无线充电器表面上的保护膜，并把吸盘贴紧于乾淨平面。
- 2 将仪表板支架套入充电器背部的固定孔，顺时针锁紧旋转球固定螺母，调整支架臂及伸缩杆至最方便合适角度。
- 3 把Type C充电线连接至电源输入端口。
- 4 将手机放在磁吸无线充电器上充电。为获得最佳效果，我们建议不要使用手机壳或手机壳必须小于 2 毫米厚度。

## 安装汽车通风夹：

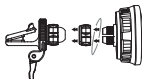

- 1** 移除磁吸无线充电器表面上的保护膜。
- 2** 将出风口夹子套入固定孔。顺时针锁紧旋转球固定螺母。
- 3** 把Type C充电线连接至电源输入端口。
- 4** 将手机放在磁吸无线充电器上充电。为获得最佳效果，我们建议不要使用手机壳或手机壳必须小于 2 毫米厚度。

 Verbatim.



R-R-3mC-IC-70CS.

1年有限质保 - 详情请浏览 [www.verbatim.com/warranty](http://www.verbatim.com/warranty)